

NUP 850/1250/1650 Thermal Plate Processor



Standard Equipment includes:-

- Input and exit tables
- Energy and water saving system
- Hinged top covers
- Platesetter interface
- Castor wheels for ease of installation
- Cycling timer
- Conductivity monitor
- Energy and water saving control system

NES Worldwide Ltd (UK)

Unit 4-8 Napier Place Stephenson Way Industrial Estate
Thetford Norfolk IP24 3RL
Tel: 01842 765128 Fax: 01842 765267
e-mail: info@nesworldwide.com

NES Worldwide Inc (USA)

3, Progress Avenue
Westfield, MA 01085
Tel: 413 562 8000 Fax: 413 564 0281
e-mail: info@nesworldwide.com

Specifications

Designed to give fast, reliable and efficient processing of most single sided thermal plates at increased transport speeds, the NUP range retains the durability, high quality and ease of operation associated with all NES processing equipment.

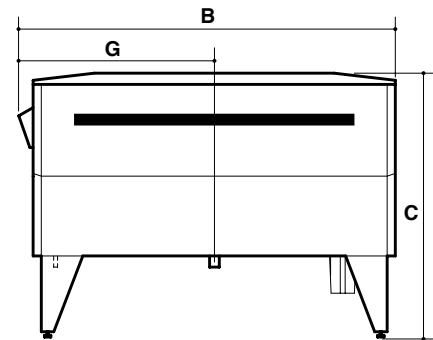
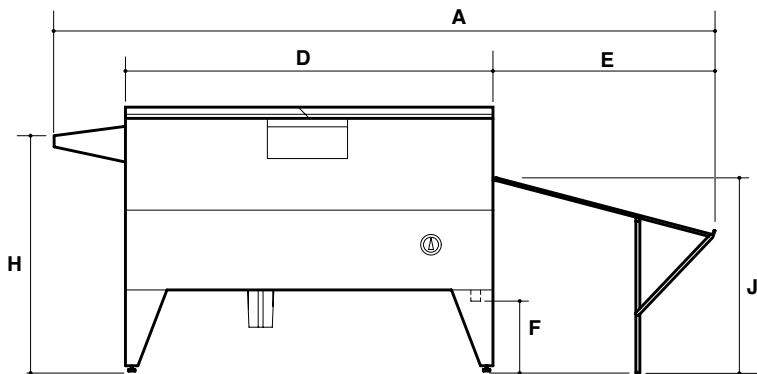

Dimensions

A	2927mm
B	1525mm (1925mm on 1250 models)
C	1110mm
D	1350mm
E	1107mm
F	390mm
G	805mm (1005mm on 1250 models)
H	920mm
J	940mm

Weight (Uncrated)

850	400 kg (882 lbs)
1250	500 kg (1102 lbs)

Plate Sizes

Max. plate width:	850	850mm (33.5")
	1250	1250mm (49.2")
Min. plate length:		330mm (13")
Plate thickness:		0.15mm (0.006") - 0.40mm (0.016")

Plate Types

Single sided thermal or conventional plates.

Plate Processing Speed

38.5" (0.98m)/min. @ 30 second dev. dwell.
55.1" (1.4m)/min. @ 21 second dev. dwell.

Scrub Roller Speed, Adjustable

Developer

Type: As recommended by plate and chemical representative.

Capacity: **850** 42 litres (11 US gallons)
1250 60 litres (15.8 US gallons)

Overflow: To waste container.

Replenishment: Per plate – adjustable 0-180 seconds (0-200ml).
Per hour – adjustable 0-3 minutes (0-200ml).

Temperature: 27°C ± 2°C (82°F ± 2°F) adjustable

Temperature maintained within tolerance only when used in conjunction with optional chiller unit.

Gum/Finisher

Type: As recommended by plate and chemical representative.

Capacity: **850** 3.5 litres (0.9 US gallons)
1250 5 litres (1.3 US gallons)

Overflow: To replenisher container.

Replenishment: Continuous when processing.

Rinse

Capacity: **850** 15 litres (4 US gallons)
1250 21 litres (5.5 US gallons)

Note: The control system employs active water saving by operating the spray bars only when the plate is passing through the rinse and tanks.
Optional recirculation units are available to further reduce water consumption.

Electrical Requirements

220-240 VAC 1N+PE 50/60Hz 20A

Optional Equipment

Water recirculation units
Developer Chiller
Mechanical Interfaces
Plate Stacker

NES Worldwide Ltd (UK)

Unit 4-8 Napier Place Stephenson Way Industrial Estate
Thetford Norfolk IP24 3RL
Tel: 01842 765128 Fax: 01842 765267
e-mail: info@nesworldwide.com

NES Worldwide Inc (USA)

3, Progress Avenue
Westfield, MA 01085
Tel: 413 562 8000 Fax: 413 564 0281
e-mail: info@nesworldwide.com