

# Sapphire 850/1250 & 850 News Preheat Plate Processor

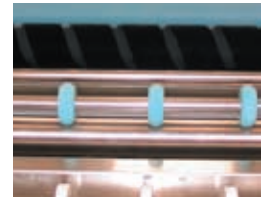

## Standard Equipment includes:-

- Input and exit tables
- Energy and water saving system
- Adjustable pre-heat temperatures to accommodate automatic switching between plate thicknesses
- Hinged top covers
- Platesetter interface
- Castor wheels for ease of installation
- Cycling timer

### **NES Worldwide Ltd (UK)**

Unit 4-8 Napier Place Stephenson Way Industrial Estate  
Thetford Norfolk IP24 3RL  
Tel: 01842 765128 Fax: 01842 765267  
e-mail: info@nesworldwide.com

### **NES Worldwide Inc (USA)**

3, Progress Avenue  
Westfield, MA 01085  
Tel: 413 562 8000 Fax: 413 564 0281  
e-mail: info@nesworldwide.com

## Specifications

Designed to give fast, reliable and efficient processing of most photopolymer CTP plates at increased transport speeds, the NES Sapphire range retains the durability, high quality and ease of operation associated with all NES processing

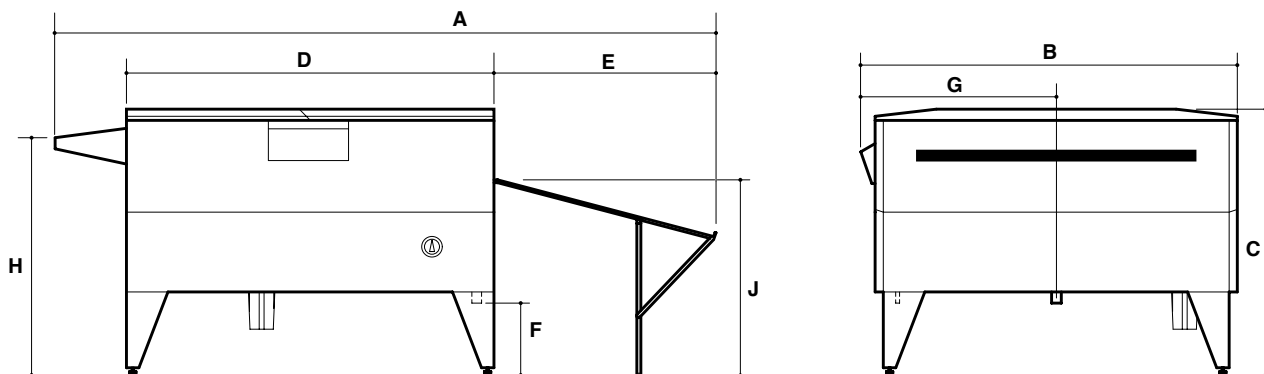

### Dimensions

A	3577mm
B	1525mm (1925mm on 1250 models)
C	1110mm
D	2000mm
E	1107mm
F	390mm
G	805mm (1005mm on 1250 models)
H	960mm
J	940mm

### Weight (Uncrated)

<b>850(News)</b>	650 kg (1430 lbs)
<b>1250</b>	725 kg (1620 lbs)

### Plate Sizes

Max. plate width:	<b>850(News)</b>	850mm (33.5")
	<b>1250</b>	1250mm (49.2")
Min. plate length:		295mm (11.6")
Plate thickness:		0.15mm (0.006") - 0.40mm (0.016")

### Plate Types

One sided photopolymer plates.

### Plate Processing Speed

#### 850/1250

38.5" (0.98m)/min. @ 30 second dev. dwell.  
55.1" (1.4m)/min. @ 21 second dev. dwell.

#### 850 News

49.2" (1.25m)/min. @ 30 second dev. dwell.  
70.9" (1.8m)/min. @ 21 second dev. dwell.

### Scrub Roller Speed, Adjustable

### Developer

Type:	As recommended by plate and chemical representative.	
Capacity:	<b>850</b>	42 litres (11 US gallons)
	<b>1250</b>	60 litres (15.8 US gallons)
	<b>850 News</b>	70 litres (18.5 US gallons)
Overflow:	To waste container.	
Replenishment:	Per plate – adjustable 0-180 seconds (0-200ml). Per hour – adjustable 0-3 minutes (0-200ml).	
Temperature:	27°C ± 2°C (82°F ± 2°F) adjustable	
	Temperature maintained within tolerance only when used in conjunction with optional chiller unit.	

### Gum/Finisher

Type:	As recommended by plate and chemical representative.	
Capacity:	<b>850(News)</b>	3.5 litres (0.9 US gallons)
	<b>1250</b>	5 litres (1.3 US gallons)
Overflow:	To replenisher container.	
Replenishment:	Continuous when processing.	

### Rinse/Prewash

Capacity:	<b>850(News)</b>	15 litres (4 US gallons)
	<b>1250</b>	21 litres (5.5 US gallons)

Note: The control system employs active water saving by operating the spray bars only when the plate is passing through the rinse and prewash tanks. Optional recirculation units are available to further reduce water consumption.

### Electrical Requirements

220-240 VAC 1N+PE 50/60Hz 40A

### Optional Equipment

Water recirculation units  
Developer Chiller  
Mechanical Interfaces  
Plate Stacker

## NES Worldwide Ltd (UK)

Unit 4-8 Napier Place Stephenson Way Industrial Estate  
Thetford Norfolk IP24 3RL  
Tel: 01842 765128 Fax: 01842 765267  
e-mail: info@nesworldwide.com

## NES Worldwide Inc (USA)

3, Progress Avenue  
Westfield, MA 01085  
Tel: 413 562 8000 Fax: 413 564 0281  
e-mail: info@nesworldwide.com