

# Sapphire 1650 Preheat Plate Processor

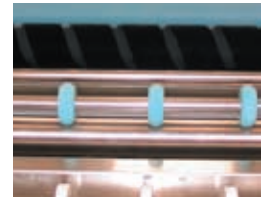

## Standard Equipment includes:-

- Input and exit tables
- Energy and water saving system
- Adjustable pre-heat temperatures to accommodate automatic switching between plate thicknesses
- Hinged top covers
- Platesetter interface
- Castor wheels for ease of installation
- Cycling timer

### NES Worldwide Ltd (UK)

Unit 4-8 Napier Place Stephenson Way Industrial Estate  
Thetford Norfolk IP24 3RL  
Tel: 01842 765128 Fax: 01842 765267  
e-mail: info@nesworldwide.com

### NES Worldwide Inc (USA)

3, Progress Avenue  
Westfield, MA 01085  
Tel: 413 562 8000 Fax: 413 564 0281  
e-mail: info@nesworldwide.com

## Sapphire 1650 Specifications

Designed to give fast, reliable and efficient processing of most photopolymer CTP plates at increased transport speeds, the NES Sapphire 1650 retains the durability, high quality and ease of operation associated with all NES processing equipment.

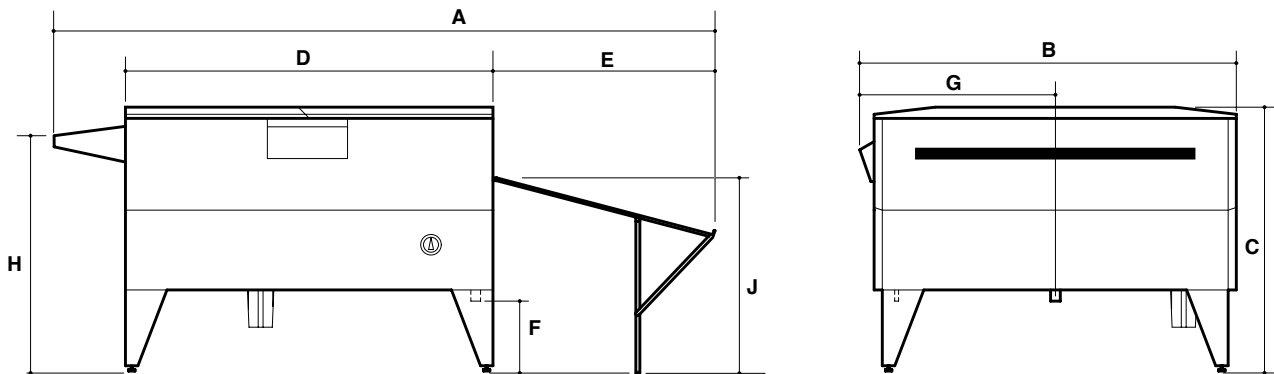

### Dimensions:

A	4924mm (5434mm input table extended)
B	2325mm
C	1182mm
D	2130mm
E	2034mm
F	390mm
G	1305mm
H	1006mm
J	986mm

### Weight (Uncrated):

850 kg (1875 lbs)

### Plate Sizes

Max. plate width: 1650mm (65")

Min. plate length: 355mm (14")

Plate thickness: 0.15mm (0.006") - 0.40mm (0.016")

### Plate Types

One sided photopolymer plates.

### Plate Processing Speed

1.06m (41.7")/min. @ 30 second dev. dwell.

1.51m (59.6")/min. @ 21 second dev. dwell.

### Scrub Roller Speed, Adjustable

### Developer

Type: As recommended by plate and chemical representative.

Capacity: 120 litres (31.7 US gallons)

Overflow: To waste container.

Replenishment: Per plate – adjustable 0-180 seconds (0-200ml).  
Per hour – adjustable 0-3 minutes (0-200ml).

Temperature: 27°C ± 2°C (82°F ± 2°F) adjustable

Temperature maintained within tolerance only when used in conjunction with optional chiller unit.

### Gum/Finisher

Type: As recommended by plate and chemical representative.

Capacity: 5 litres (1.3 US gallons)

Overflow: To replenisher container.

Replenishment: Continuous when processing.

### Rinse/Prewash

Capacity: 25 litres (6.6 US gallons)

Note: The control system employs active water saving by operating the spray bars only when the plate is passing through the rinse and prewash tanks. Optional recirculation units are available to further reduce water consumption.

### Electrical Requirements

380-415 VAC 3 phase+PE 50/60Hz 16A per phase

### Optional Equipment

Water recirculation units

Developer Chiller

Mechanical Interfaces

Plate Stacker

## NES Worldwide Ltd (UK)

Unit 4-8 Napier Place Stephenson Way Industrial Estate

Thetford Norfolk IP24 3RL

Tel: 01842 765128 Fax: 01842 765267

e-mail: info@nesworldwide.com

## NES Worldwide Inc (USA)

3, Progress Avenue

Westfield, MA 01085

Tel: 413 562 8000 Fax: 413 564 0281

e-mail: info@nesworldwide.com